

Technical data sheet



Product features

Bain marie electric 2x GN 1/1 - 150 counter top

| | | |
|--------------|-----------------|----------|
| Model | SAP Code | 00000059 |
|--------------|-----------------|----------|



- Drain: No
- Material: Stainless steel
- Protection of controls: IPX4
- Maximum device temperature [°C]: 90

| | | | |
|------------------------|----------|-------------------------------|--------------------|
| SAP Code | 00000059 | Power electric [kW] | 3.000 |
| Net Width [mm] | 660 | Loading | 230 V / 1N - 50 Hz |
| Net Depth [mm] | 535 | Number of GN / EN | 2 |
| Net Height [mm] | 229 | GN / EN size in device | GN 1/1 |
| Net Weight [kg] | 17.00 | GN device depth | 150 |

Technical data sheet



Technical drawing

Bain marie electric 2x GN 1/1 - 150 counter top

Model

SAP Code

00000059

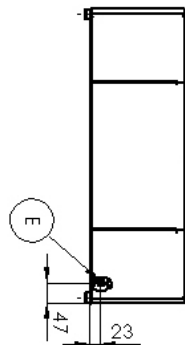
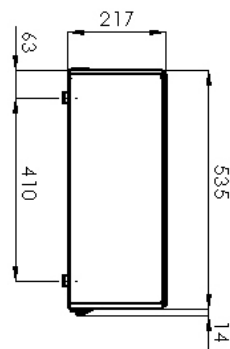
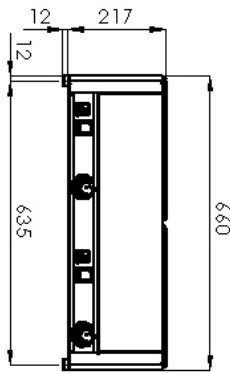

Technical data sheet



Product benefits

Bain marie electric 2x GN 1/1 - 150 counter top

Model

SAP Code

00000059

1

All-stainless design

long life
resistance of AISI 304 stainless steel material
the material does not cut

- savings on service interventions
- easy cleaning and maintenance of equipment

2

Degree of protection of the control elements IPX4

maintenance-free system
resistance to splash water
long life

- savings on service interventions
- easy cleaning and maintenance of equipment

3

Easy manipulation

easy portability

- flexibility in the kitchen, can be used for banquets

Technical data sheet



Technical parameters

Bain marie electric 2x GN 1/1 - 150 counter top

Model

SAP Code

00000059

1. SAP Code:

00000059

2. Net Width [mm]:

660

3. Net Depth [mm]:

535

4. Net Height [mm]:

229

5. Net Weight [kg]:

17.00

6. Gross Width [mm]:

580

7. Gross depth [mm]:

700

8. Gross Height [mm]:

240

9. Gross Weight [kg]:

19.00

10. Device type:

Electric unit

11. Construction type of device:

Table top

12. Power electric [kW]:

3.000

13. Loading:

230 V / 1N - 50 Hz

14. Protection of controls:

IPX4

15. Material:

Stainless steel

16. Indicators:

operation and warm-up

17. Maximum device temperature [°C]:

90

18. Minimum device temperature [°C]:

30

19. Drain:

No

20. Number of GN / EN:

2

21. GN / EN size in device:

GN 1/1

22. GN device depth:

150

23. Heating location:

Under the bottom of the bathtub